

FP-001 → → → **PROGRAMMER**



General Specification :

Voltage : +5VDC \pm 3%

Current : 120mA (Max) 90mA (Min)

Power Consumption : 0.6W (Max) 0.45W (Min)

Size : (Length)108mm X (Width) 86mm X (Thickness) 29mm

Operating Temperature : 0°C~ 70°C

Operating Humidity : 0% ~ 65% (RH)

Use of Materials Limitations

International Currency Technologies Corporation (ICT) all rights reserved.

All materials contained are the copyrighted property of ICT.

All trademarks, service marks, and trade names are proprietary to ICT.

ICT reserves the right at all times to disclose or to modify any information as ICT deems necessary to satisfy any applicable law, regulation, legal process or governmental request, or to edit, refuse to post or to remove any information or materials, in whole or in part, in ICT's sole discretion.

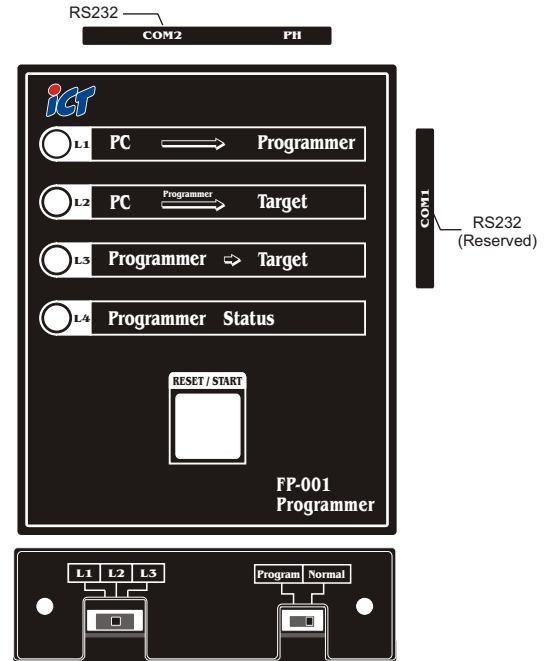

Indirect Downloading :

PC ⇄ Programmer

Step 1 : Connection

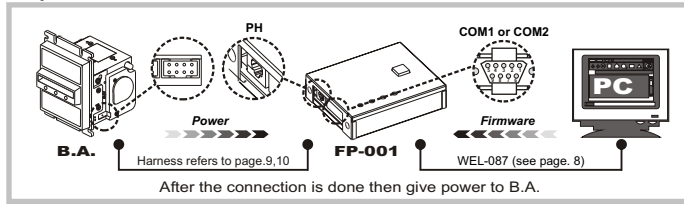

Step 2 : FP-001 setting

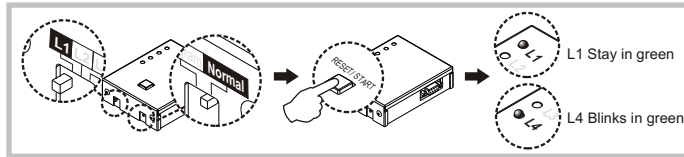

Step 3 : Launch software FW16.exe. Download FW16.exe from <http://www.ictgroup.com.tw/> → support

Step 4 : FW16 setting

CPU MB90F549 Speed 16MHz Port COM1 or COM2
The com port setting varies according to the connection on PC.

Step 5 : Retrieve the firmware path.

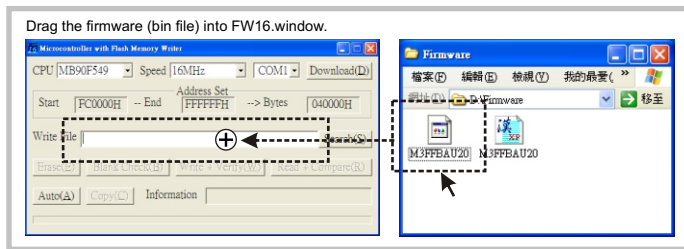

Step 6 : Start downloading to FP-001.



Step 7 : Firmware is saved in the FP-001 now.(Final)

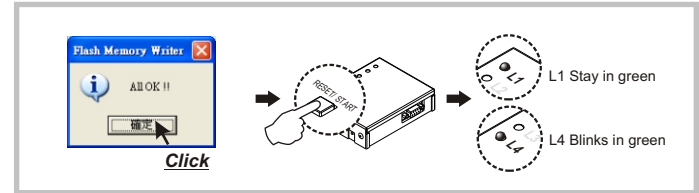

Upgrade to Different Currency Programmer → Target

Step 1 : Connection.

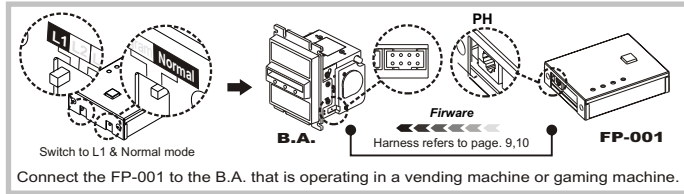

Step 2 : FP-001 setting.

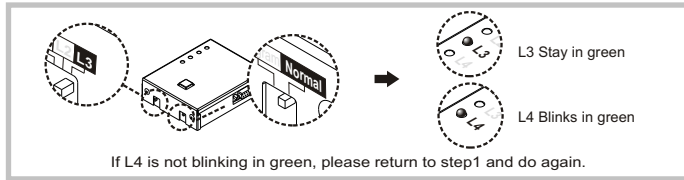

Step 3 : Start downloading to B.A..

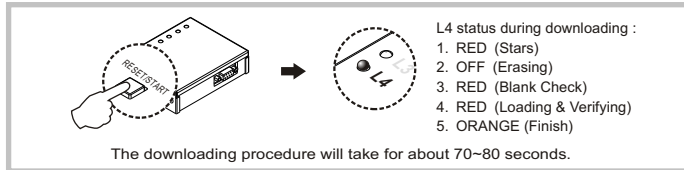

Step 4 : White card calibration.

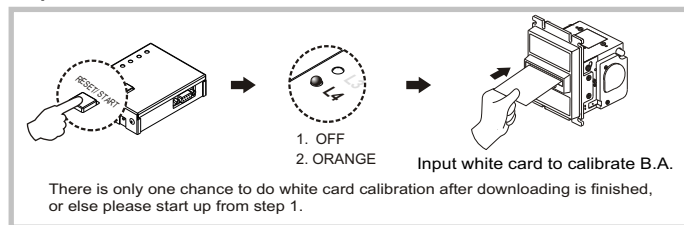

Step 5 : Indirect downloading finish.

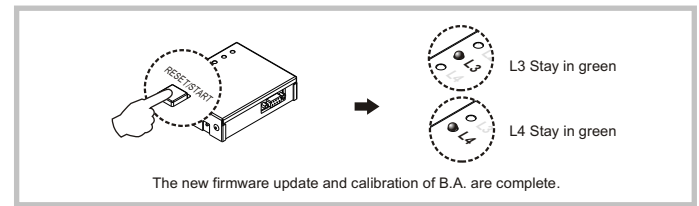

Step 6 : Reset B.A. (Final).

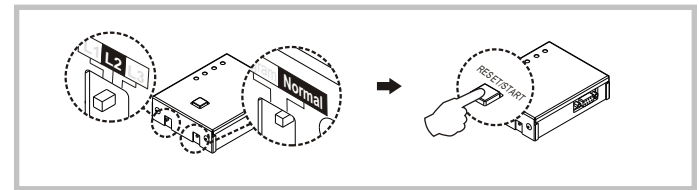

Very Important

1. If there is no com port but USB available on your PC , you can buy the (USB-to-Serial Comm Port) adapter for the FP-001 to PC connection. The (USB-to-Serial Comm Port) may be available in the shop which sells PC and it's peripherals.
2. All bill acceptor must be calibrated with a white card after its firmware is upgraded to different currency.
3. The white card must be offered by I.C.T.

Upgrade to Same Currency

Programmer ⇨ Target

Step 1 : Connection.

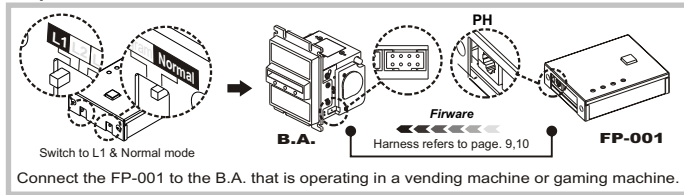

Step 2 : FP-001 setting.

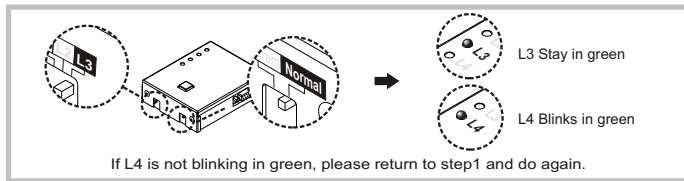

Step 3 : Start downloading to B.A..

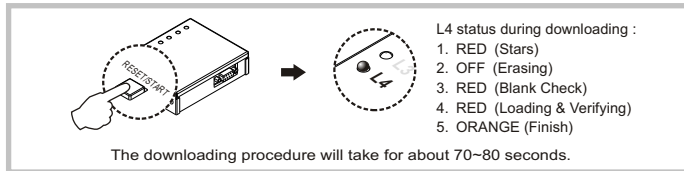

Step 4 : Reset B.A. (Final).

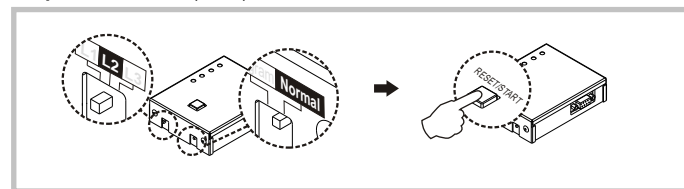

Direct Downloading :

Step 1 : Connection

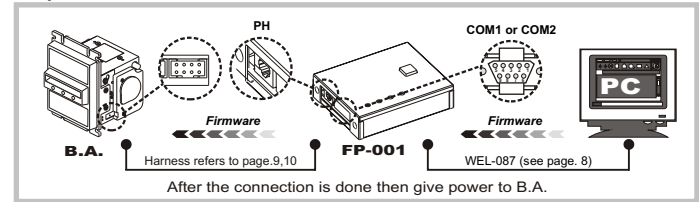

Step 2 : FP-001 setting

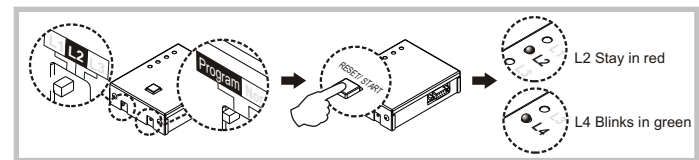

Step 3 : Launch software FW16.exe.

Download FW16.exe from <http://www.ictgroup.com.tw/> ⇨ support

Step 4 : FW16 setting

CPU MB90F549 Speed 16MHz Port COM1 or COM2
The com port setting varies according to the connection on PC.

Step 5 : Retrieve the firmware path.

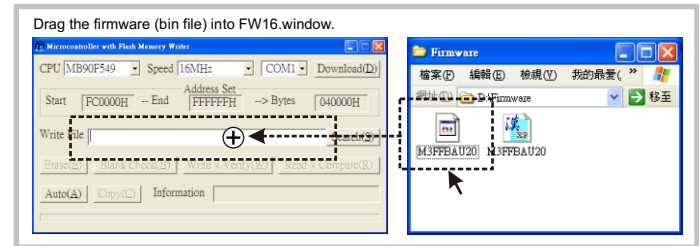

Step 6 : Start downloading to B.A..



Click Auto(A) button to download firmware into B.A..

The downloading procedure will take for about 60~75 seconds.

Step 7 : Firmware downloading to B.A. finish.



The new program will pass through the FP-001 programmer and load into the B.A..

How ever the new program will not be stored in FP-001 programmer.

Click

Step 8 : Switch FP-001 to Normal mode.

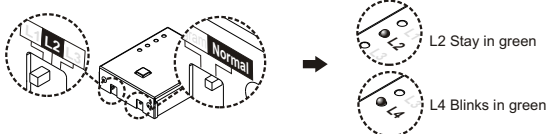

L2 Stay in green

L4 Blinks in green

Step 9 : Reset B.A. (Final).

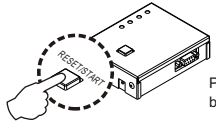

Press down < Reset / Start > button of FP-001 then B.A. will reset.



Very Important

1. All bill acceptor must be calibrated with a white card after its firmware is upgraded to different currency.
2. The white card must be offered by I.C.T.
3. The B.A. White card calibration manual please download from <http://www.ictgroup.com.tw/> ➔ support

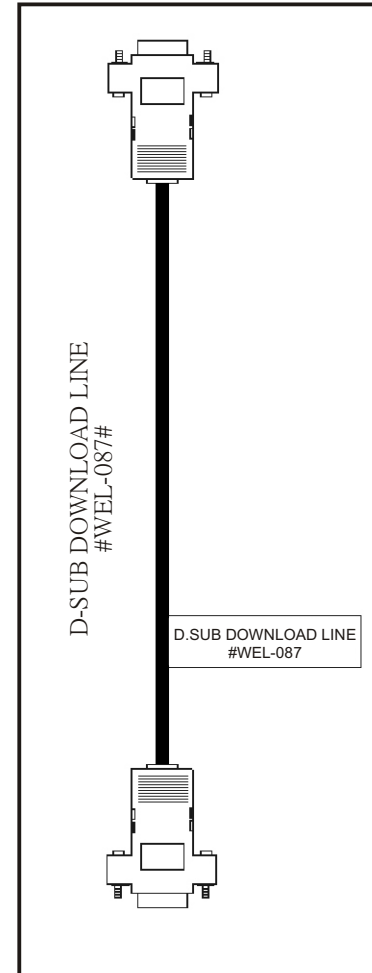

This harness WEL-087 is for FP-001 to PC connection.

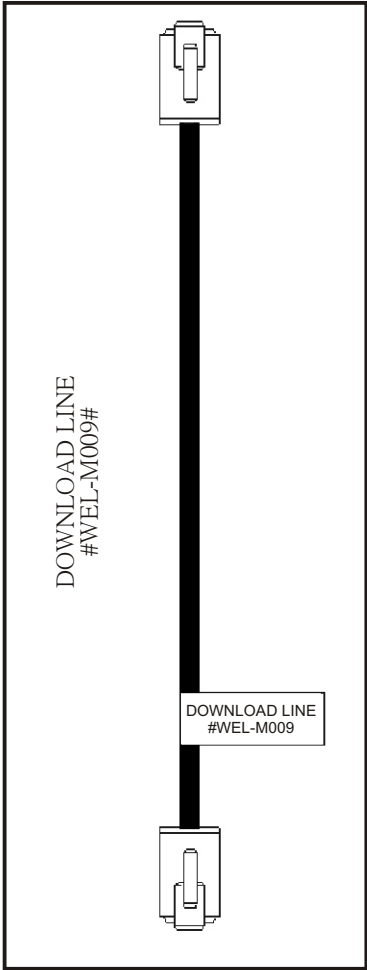

This harness WEL-M009 is for 6 series , 7 series, Note Dispenser and GP-58 series.

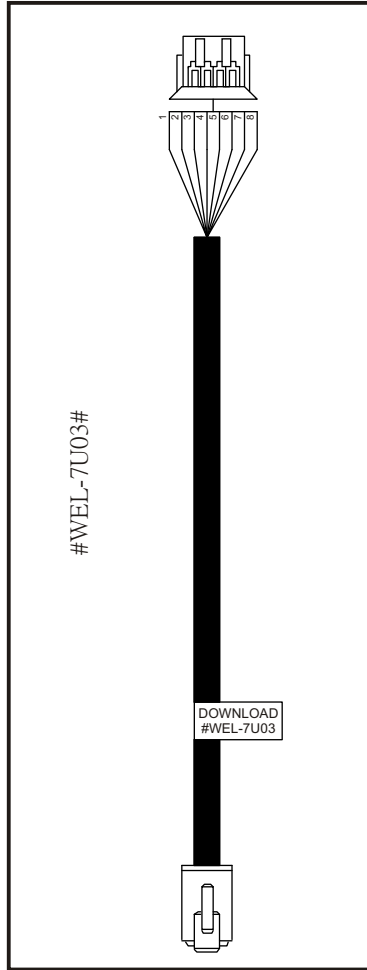

This harness WEL-7U03 is for U series , UF series, Leonid and MCA series.

ict Taiwan

International Currency Technologies Corporation

Ji-Hong Building, No 24, Alley 38, Lane 91, Nei-hu Rd., Sec. 1,
Taipei, Taiwan, R.O.C.

Tel: 886-2-2797-1238 Fax:886-2-2797-1634

sales@ictgroup.com.tw (For Sales)

rma@ictgroup.com.tw (For Customer service)